

### 30" (762) Warming Drawer

#### MODEL WWD30 - STAINLESS STEEL DRAWER FRONT

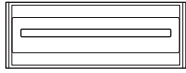

Model WWD30  
Stainless Steel Drawer Front

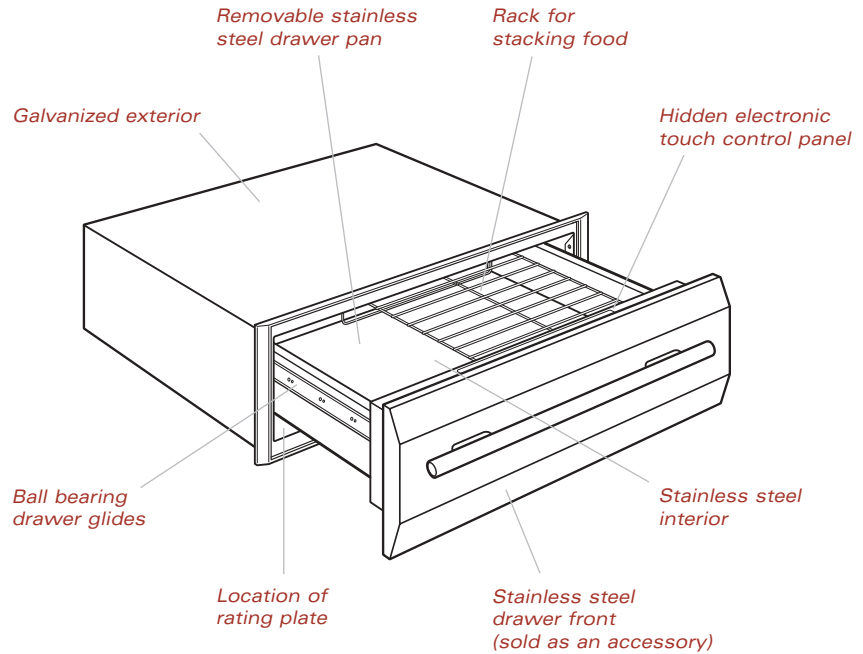

► The Wolf Model WWD30, 30" (762) warming drawer is sold as a base unit only, a drawer front accessory is required. The stainless steel drawer front panel and tubular handle is available in classic, platinum or carbon stainless steel finish.



This appliance is certified by Star-K to meet strict religious regulations in conjunction with specific instructions found on [www.star-k.org](http://www.star-k.org).

**W**arming drawers have a clear mission in life—to take good care of good food until it’s time for you to eat. Our superior air control helps keep moist foods moist and crisp foods crisp. In addition, Wolf warming drawers are some of the most capacious on the market, so you will have little problem storing items.

Electronic controls are hidden. You have your choice of three stainless steel finishes for the drawer front and handle. Choose from the classic stainless steel look or the premium finishes of platinum or carbon stainless steel.

## 30" (762) Warming Drawer

### MODEL WWD30 - STAINLESS STEEL DRAWER FRONT

#### FEATURES

- ▶ Stainless steel drawer front and tubular handle available in classic, platinum and carbon finishes
- ▶ 850-watt heating element
- ▶ Hidden electronic touch control panel
- ▶ Preset and variable temperature control
- ▶ Preset automatic shut-off or extended operation in Sabbath Mode
- ▶ Stainless steel interior
- ▶ Rack for stacking food
- ▶ Removable stainless steel drawer pan
- ▶ Full extension, ball bearing drawer glides
- ▶ Certified by Star-K to meet religious regulations
- ▶ CSA certified for US and Canada
- ▶ Two and five year residential warranty - exclusions apply; warranty information can be found on our website, [wolfappliance.com](http://wolfappliance.com)

#### OVERALL DIMENSIONS ▼

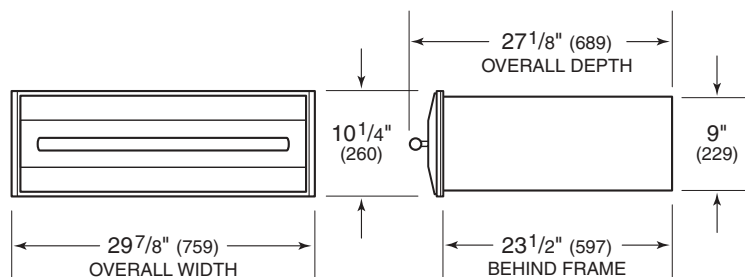

*Model WWD30 with stainless steel drawer front.*

*Dimensions may vary by  $\pm 1/8$ " (3).*

*Dimensions in parentheses are in millimeters unless otherwise specified.*

## 30" (762) Warming Drawer

### MODEL WWD30 - STAINLESS STEEL DRAWER FRONT

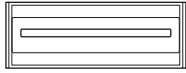

Model WWD30  
Stainless Steel Drawer Front

#### FRONT PANEL OPTIONS ▼

Classic Stainless Steel WWDFRONT/S

Platinum Stainless Steel WWDFRONT/P

Carbon Stainless Steel WWDFRONT/B

*Warming drawer is sold as a base unit only, one of the above stainless steel drawer front panels is required. Panels are ordered and shipped as a sales accessory and include a tubular handle.*

#### ACCESSORIES

- ▶ Six-piece container set with lids and pan rack

*Accessories are available through your Wolf dealer. To obtain local dealer information, visit the Locator section of our website, [wolfappliance.com](http://wolfappliance.com).*

#### SPECIFICATIONS ▼

Overall Drawer Width	29 <sup>7</sup> / <sub>8</sub> " (759)
Overall Drawer Height	10 <sup>1</sup> / <sub>4</sub> " (260)
Overall Drawer Depth	27 <sup>1</sup> / <sub>8</sub> " (689)
Overall Depth (behind frame)	23 <sup>1</sup> / <sub>2</sub> " (597)
Recommended Cabinet Width	33" (838)
Minimum Cabinet Width	30" (762)
Minimum Cabinet Depth	24" (610)
Minimum Base Support	200 lbs (91 kg)
Rough Opening Width	28 <sup>5</sup> / <sub>8</sub> " (727)
Rough Opening Height	9 <sup>1</sup> / <sub>8</sub> " (232)
Rough Opening Depth	23 <sup>7</sup> / <sub>8</sub> " (606)
Heating Element	850 W
Electrical Supply Requirements	110/120 V AC, 50/60 Hz 15 amp dedicated circuit
Power Cord	6 ft (1.8 m) power cord with 3-prong grounded plug
Shipping Weight	100 lbs (45 kg)
Special Note	Installation specifications vary for stainless steel drawer front and integrated drawer front applications

*Specifications are subject to change without notice.*

*Dimensions may vary by ±<sup>1</sup>/<sub>8</sub>" (3).*

*Dimensions in parentheses are in millimeters unless otherwise specified.*

### 30" (762) Warming Drawer

#### MODEL WWD30 - STAINLESS STEEL DRAWER FRONT

#### INSTALLATION WITH 30" (762) BUILT-IN OVEN

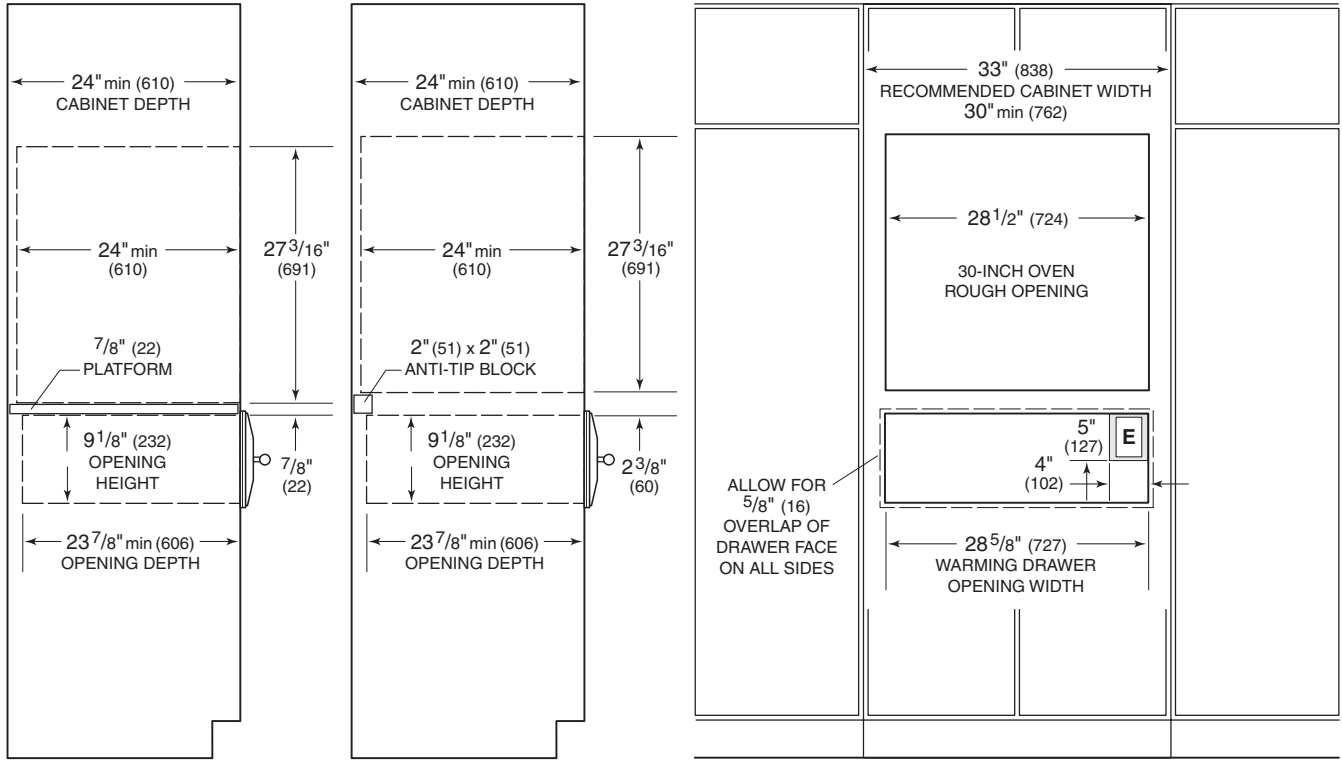

PLATFORM APPLICATION

ANTI-TIP BLOCK APPLICATION

NOTE: Refer to the built-in 30" (762) single oven specifications for electrical location.

#### UNDERCOUNTER INSTALLATION

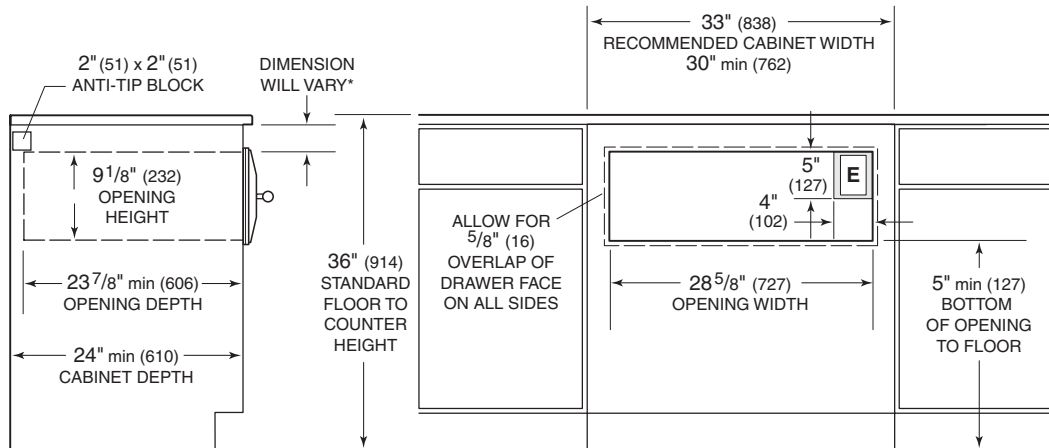

\*Allow enough room for placement of anti-tip block and drawer face overlap.

Dimensions shown in the illustrations are for the stainless steel drawer front application.

Dimensions in parentheses are in millimeters unless otherwise specified.

## 30" (762) Warming Drawer

### MODEL WWD30 - STAINLESS STEEL DRAWER FRONT

#### INSTALLATION NOTES

- ▶ Refer to the illustrations and specifications for overall dimensions, finished rough opening dimensions and installation specifics.
- ▶ The Wolf warming drawer is shipped without any decorative drawer front. You must order one of three stainless steel drawer fronts (handle included)—classic, platinum or carbon finish.
- ▶ Dimensions shown in the installation illustrations on the previous page are for stainless steel drawer front applications. Refer to the installation instructions provided with the drawer front for detailed specifications.
- ▶ Wolf recommends using a 33" (838) wide cabinet for the warming drawer with stainless steel drawer front. A minimum 30" (762) wide by 24" (610) deep cabinet is required.
- ▶ The warming drawer platform must be able to support 200 lbs (91 kg). It must be a minimum of 1" (25) above the toe kick to allow for the overlap of the warming drawer trim.

**IMPORTANT NOTE:** A platform or anti-tip block must be installed to prevent the unit from tipping forward when the drawer is opened.

- ▶ For undercounter installations, 23<sup>1</sup>/<sub>2</sub>" (597) from the bottom of the warming drawer opening to the floor is recommended.
- ▶ The Wolf warming drawer requires a separate, grounded 110/120 V AC, 50/60 Hz power supply. The service should have its own 15 amp circuit breaker and a grounded 3-prong receptacle should be located within the reach of the 6' (1.8 m) power cord, and flush with the back wall. Locate electrical within the shaded area shown in the installation illustrations.
- ▶ You must follow all National Electrical Code regulations. In addition, be aware of local codes and ordinances when installing your service.
- ▶ The Wolf warming drawer with stainless steel drawer front may be installed below an electric or gas cooktop, provided the warming drawer is fully enclosed, top and bottom. Refer to the Electric or Gas Cooktops section of our website, wolfappliance.com for additional specifications.

- ▶ The Wolf warming drawer with stainless steel drawer front may be installed below or above a Wolf 30" (762) built-in single oven or below a double oven, provided the warming drawer is fully enclosed, top and bottom. The Wolf warming drawer is designed and agency approved for installation with Wolf built-in ovens. Refer to the Built-in Ovens section of our website, wolfappliance.com for additional specifications.

- ▶ When the warming drawer is installed below a built-in oven, a minimum of 2<sup>3</sup>/<sub>8</sub>" (60) between warming drawer and oven openings is required for placement of the anti-tip block. To allow the warming drawer trim and the built-in oven trim to meet, a 7/8" (22) platform may be used to separate the two openings. This will act as the support platform for the oven and the anti-tip device for the warming drawer. Refer to the installation illustrations for both applications.

**IMPORTANT NOTE:** Additional clearance between warming drawer and oven openings may be required. Check that oven supports do not obstruct the interior dimensions required for the warming drawer.

**IMPORTANT NOTE:** When the warming drawer is installed above a built-in oven, a 7/8" (22) platform is required to allow for clearance of overlaps.

- ▶ The Wolf warming drawer with stainless steel drawer front may be installed next to or above another Wolf warming drawer.
- ▶ The Wolf warming drawer with stainless steel drawer front may be installed in combination with a 30" (762) single oven and microwave oven with 30" (762) trim. Refer to pages 6 and 7 for installation specifications.
- ▶ The Wolf warming drawer is designed and safe for use in outdoor applications. When installed outdoors, a ground fault circuit interrupter (GFCI) is required to reduce the risk of electrical shock. All other aspects of the installation are identical for indoor and outdoor use.
- ▶ Refer to the installation instructions shipped with each Wolf product for detailed specifications.

### 30" (762) Warming Drawer

#### MODEL WWD30 - STAINLESS STEEL DRAWER FRONT

#### CONVECTION MICROWAVE, BUILT-IN OVEN AND WARMING DRAWER

The Wolf convection microwave oven with 30" (762) trim may be installed in combination with a 30" (762) built-in single oven and 30" (762) warming drawer with stainless steel drawer front.

Wolf recommends using 33" (838) cabinets with this installation. Also, you need a minimum 24" (610) of usable cabinet depth for the oven.

The base platform for the microwave must be able to support 125 lbs (57 kg). The platform for the oven must be able to support a weight of 250 lbs (113 kg). And the warming drawer platform must be able to support 200 lbs (91 kg).

An anti-tip block or platform must be installed to prevent the warming drawer from tipping forward when the drawer is opened. The warming drawer must be fully enclosed, top and bottom.

For electrical requirements and additional specifications, refer to page 5, and to the Built-In Ovens and Microwave Ovens pages on the Wolf website at [wolfappliance.com](http://wolfappliance.com). Also refer to the installation instructions provided with each microwave trim kit and warming drawer front for detailed specifications.

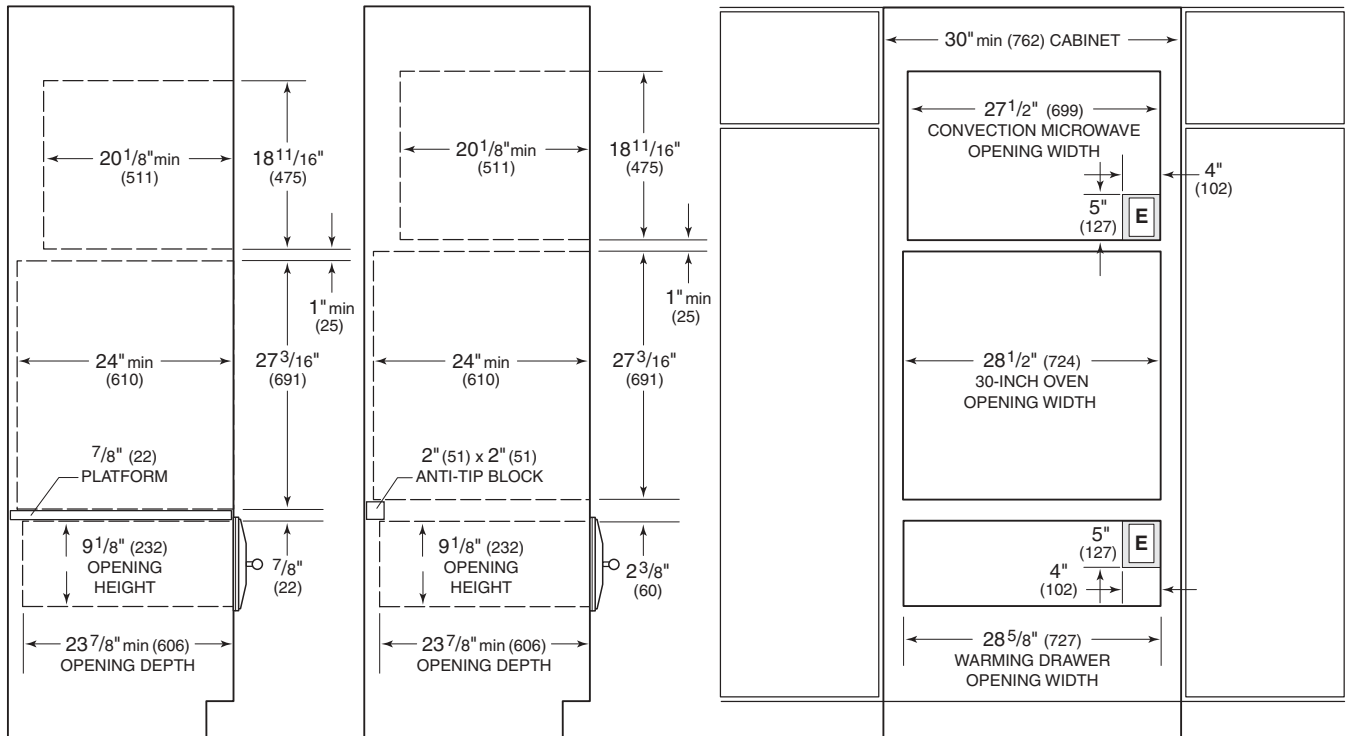

PLATFORM APPLICATION

ANTI-TIP BLOCK APPLICATION

NOTE: Refer to the built-in 30" (762) single oven specifications for electrical location.

Installation specifications for a convection microwave with 30" (762) trim installed above a 30" (762) built-in single oven and 30" (762) warming drawer with stainless steel drawer front.

Dimensions may vary by  $\pm 1/8"$  (3).

Dimensions in parentheses are in millimeters unless otherwise specified.

### 30" (762) Warming Drawer

#### MODEL WWD30 - STAINLESS STEEL DRAWER FRONT

#### NON-CONVECTION MICROWAVE, OVEN AND WARMING DRAWER

The Wolf non-convection microwave oven with 30" (762) trim may be installed in combination with a 30" (762) built-in single oven and 30" (762) warming drawer with stainless steel drawer front.

Wolf recommends using 33" (838) cabinets with this installation. Also, you need a minimum 24" (610) of usable cabinet depth for the oven.

The base platform for the microwave must be able to support 125 lbs (57 kg). The platform for the oven must be able to support a weight of 250 lbs (113 kg). And the warming drawer platform must be able to support 200 lbs (91 kg).

An anti-tip block or platform must be installed to prevent the warming drawer from tipping forward when the drawer is opened. The warming drawer must be fully enclosed, top and bottom.

For electrical requirements and additional specifications, refer to page 5, and to the Built-In Ovens and Microwave Ovens pages on the Wolf website at [wolfappliance.com](http://wolfappliance.com). Also refer to the installation instructions provided with each microwave trim kit and warming drawer front for detailed specifications.

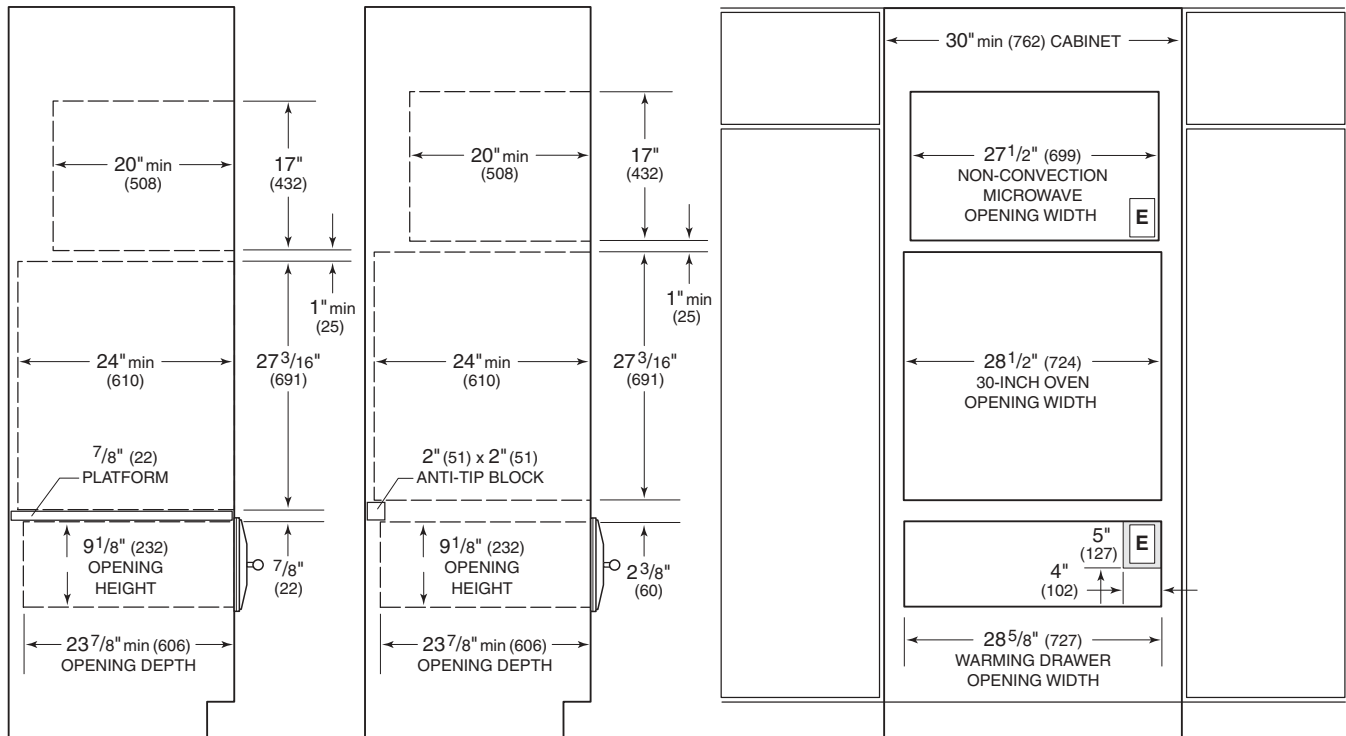

PLATFORM APPLICATION

ANTI-TIP BLOCK APPLICATION

NOTE: Refer to the built-in 30" (762) single oven specifications for electrical location.

Installation specifications for a non-convection microwave with 30" (762) trim installed above a 30" (762) built-in single oven and 30" (762) warming drawer with stainless steel drawer front.

Dimensions may vary by  $\pm 1/8$ " (3).

Dimensions in parentheses are in millimeters unless otherwise specified.

### 30" (762) Warming Drawer

#### MODEL WWD30 - INTEGRATED DRAWER FRONT



Model WWD30  
Integrated Drawer Front

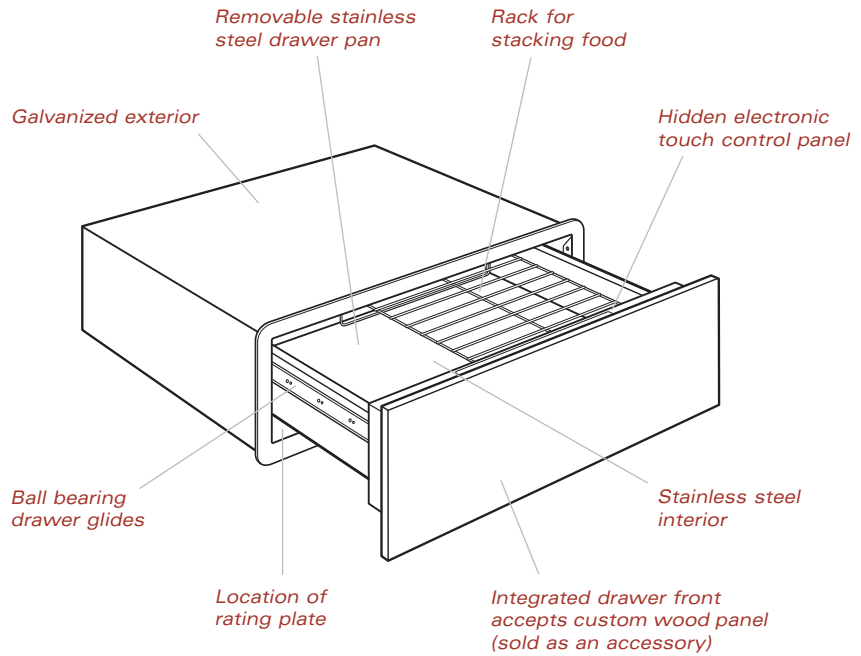

► The Wolf Model WWD30, 30" (762) warming drawer is sold as a base unit only, a drawer front accessory is required. The integrated drawer front allows for a custom wood panel and handle hardware.

**W**arming drawers have a clear mission in life—to take good care of good food until it’s time for you to eat. Our superior air control helps keep moist foods moist and crisp foods crisp. In addition, Wolf warming drawers are some of the most capacious on the market, so you will have little problem storing items.

The Wolf warming drawer with integrated drawer front allows for a custom wood panel and handle hardware. Electronic controls are hidden to allow the unit to become completely integrated with surrounding cabinetry.



This appliance is certified by Star-K to meet strict religious regulations in conjunction with specific instructions found on [www.star-k.org](http://www.star-k.org).

### 30" (762) Warming Drawer

#### MODEL WWD30 - INTEGRATED DRAWER FRONT

#### FEATURES

- ▶ Integrated drawer front allows for custom wood panel application
- ▶ 850-watt heating element
- ▶ Hidden electronic touch control panel
- ▶ Preset and variable temperature control
- ▶ Preset automatic shut-off or extended operation in Sabbath Mode
- ▶ Stainless steel interior
- ▶ Rack for stacking food
- ▶ Removable stainless steel drawer pan
- ▶ Full extension, ball bearing drawer glides
- ▶ Certified by Star-K to meet religious regulations
- ▶ CSA certified for US and Canada
- ▶ Two and five year residential warranty - exclusions apply; warranty information can be found on our website, [wolfappliance.com](http://wolfappliance.com)

#### OVERALL DIMENSIONS ▼

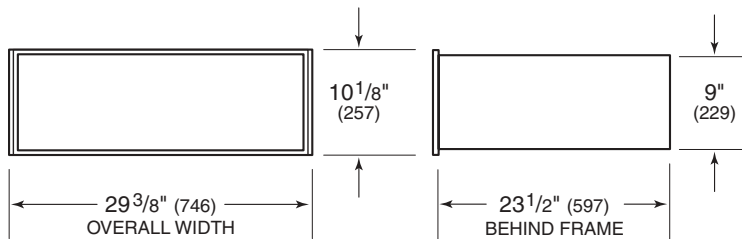

*Model WWD30 with integrated drawer front.*

*Dimensions may vary by  $\pm 1/8$ " (3).*

*Dimensions in parentheses are in millimeters unless otherwise specified.*

## 30" (762) Warming Drawer

### MODEL WWD30 - INTEGRATED DRAWER FRONT



Model WWD30  
Integrated Drawer Front

#### DRAWER FRONT PANEL ▼

Integrated WWD30FRONT/I  
(accepts wood panel)

*Warming drawer is sold as a base unit only, the integrated drawer front panel is required. It is ordered and shipped as a sales accessory.*

#### ACCESSORIES

- ▶ Tubular handle for integrated drawer front in classic, platinum or carbon stainless steel
- ▶ Six-piece container set with lids and pan rack

*Accessories are available through your Wolf dealer. To obtain local dealer information, visit the Locator section of our website, [wolfappliance.com](http://wolfappliance.com).*

#### SPECIFICATIONS ▼

Overall Drawer Width	29 <sup>3</sup> / <sub>8</sub> " (746)
Overall Drawer Height	10 <sup>1</sup> / <sub>8</sub> " (257)
Overall Drawer Depth (behind frame)	23 <sup>1</sup> / <sub>2</sub> " (597)
Minimum Cabinet Width	33" (838)
Minimum Cabinet Depth	
Overlay	24" (610)
Inset	25" (635)
Minimum Base Support	200 lbs (91 kg)
Opening Width	29 <sup>1</sup> / <sub>2</sub> " (749)
Opening Height	10 <sup>1</sup> / <sub>4</sub> " (260)
Opening Depth**	24" (610)
Minimum Panel Size	
Overlay	30" (762) W x 10 <sup>3</sup> / <sub>8</sub> " (264) H
Inset	29 <sup>3</sup> / <sub>8</sub> " (746) W x 10 <sup>1</sup> / <sub>8</sub> " (257) H
Minimum Panel Thickness	<sup>5</sup> / <sub>8</sub> " (16)
Maximum Panel Weight	25 lbs (11 kg)
Heating Element	850 W
Electrical Supply Requirements	110/120 V AC, 50/60 Hz 15 amp dedicated circuit
Power Cord	6 ft (1.8 m) power cord with 3-prong grounded plug
Shipping Weight	100 lbs (45 kg)
Special Note	Installation specifications vary for overlay and inset panel applications

*Specifications are subject to change without notice.*

*Dimensions may vary by ±1/8" (3).*

*Dimensions in parentheses are in millimeters unless otherwise specified.*

### 30" (762) Warming Drawer

#### MODEL WWD30 - INTEGRATED DRAWER FRONT

#### UNDERCOUNTER - OVERLAY APPLICATION

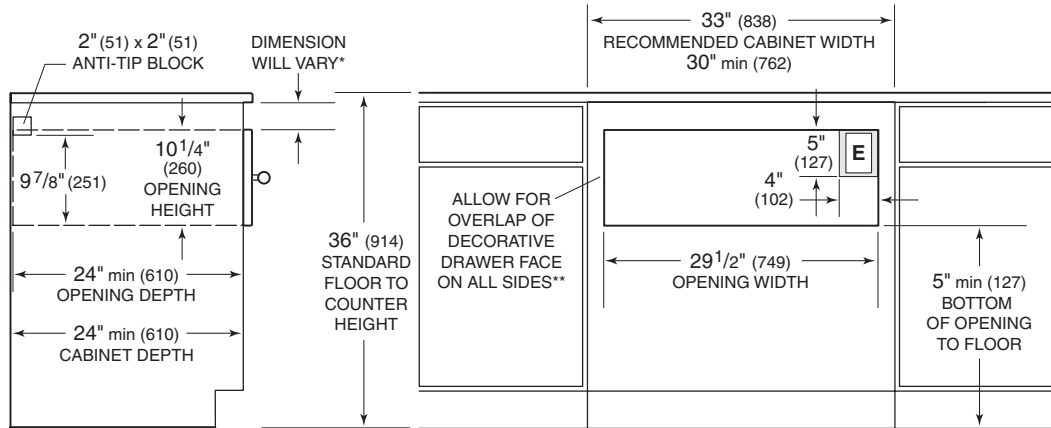

\*Allow enough room for placement of anti-tip block and drawer face overlap.  
\*\*Overlap of decorative drawer face will vary depending on the size of the custom panel.

#### UNDERCOUNTER - INSET APPLICATION

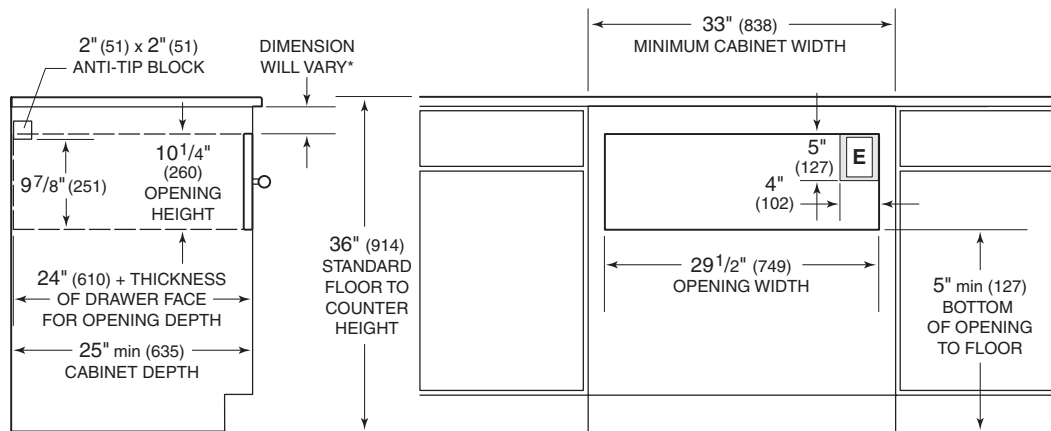

\*Allow enough room for placement of anti-tip block.

Dimensions shown in the illustrations are for the integrated drawer front application.

Dimensions in parentheses are in millimeters unless otherwise specified.

**30" (762) Warming Drawer**

**MODEL WWD30 - INTEGRATED DRAWER FRONT**

**INSTALLATION WITH 30" (762) BUILT-IN OVEN**

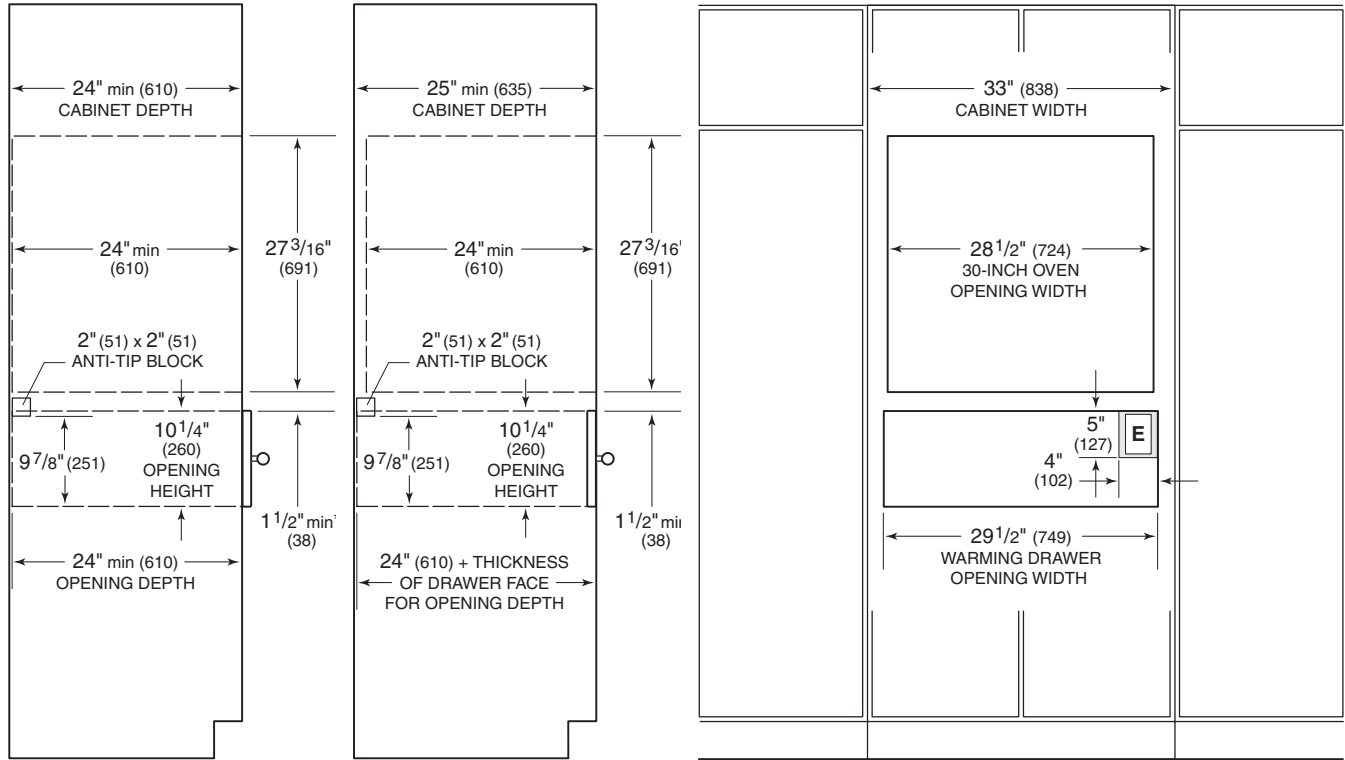

OVERLAY APPLICATION

INSET APPLICATION

NOTE: Refer to the built-in 30" (762) single oven specifications for electrical location.

\*Dimension may increase depending on the size of the drawer front panel.

Dimensions shown in the illustrations are for the integrated drawer front application.

Dimensions may vary by  $\pm 1/8"$  (3).

Dimensions in parentheses are in millimeters unless otherwise specified.

## 30" (762) Warming Drawer

### MODEL WWD30 - INTEGRATED DRAWER FRONT

#### INSTALLATION NOTES

- ▶ Refer to the illustrations and specifications for overall dimensions, finished rough opening dimensions and installation specifics.
  - ▶ The Wolf warming drawer is shipped without any decorative drawer front. You must order the integrated drawer front (no handle) for a custom wood application. The decorative wood drawer front panel must be a minimum of  $\frac{5}{8}$ " (16) thick.
- The warming drawer with integrated drawer front can be used in an overlay application or an inset panel application where it will be completely recessed into the cabinet. Keep in mind that the size of the custom panel for the warming drawer with integrated drawer front will vary according to the specific installation.
- ▶ Dimensions shown in the installation illustrations on the previous pages are for the integrated drawer front application. Refer to the installation instructions provided with the integrated drawer front for detailed specifications.
  - ▶ A minimum 33" (838) wide cabinet is required for the warming drawer with integrated drawer front.

**IMPORTANT NOTE:** The inset panel application requires the warming drawer to be recessed into the cabinet. A minimum 25" (635) deep cabinet is needed if you want the front panel to be flush with surrounding cabinetry.

- ▶ The warming drawer platform must be able to support 200 lbs (91 kg). It must be a minimum of 1" (25) above the toe kick to allow for the overlap of the warming drawer trim.

**IMPORTANT NOTE:** An anti-tip block must be installed to prevent the unit from tipping forward when the drawer is opened.

- ▶ For undercounter installations, 23 $\frac{1}{2}$ " (597) from the bottom of the warming drawer opening to the floor is recommended.
- ▶ The Wolf warming drawer requires a separate, grounded 110/120 V AC, 50/60 Hz power supply. The service should have its own 15 amp circuit breaker and a grounded 3-prong receptacle should be located within the reach of the 6' (1.8 m) power cord, and flush with the back wall. Locate electrical within the shaded area shown in the installation illustrations.

- ▶ The Wolf warming drawer with integrated drawer front may be installed below a 30" (762) or 36" (914) wide electric or gas cooktop, provided the warming drawer is fully enclosed, top and bottom. Refer to the Electric or Gas Cooktops section of our website, [wolfappliance.com](http://wolfappliance.com) for additional specifications.

- ▶ The Wolf warming drawer with integrated drawer front may be installed below or above a Wolf 30" (762) or 36" (914) built-in single oven, provided the warming drawer is fully enclosed, top and bottom. The Wolf warming drawer is designed and agency approved for installation with Wolf built-in ovens. Refer to the Built-in Ovens section of our website, [wolfappliance.com](http://wolfappliance.com) for additional specifications.

- ▶ When the warming drawer is installed below a built-in oven, a minimum of 1 $\frac{1}{2}$ " (38) between warming drawer and oven openings is required for placement of the anti-tip block and oven platform. When installed above a built-in oven, a minimum of  $\frac{7}{8}$ " (22) is required.

**IMPORTANT NOTE:** Additional clearance between warming drawer and oven openings may be required. Check that oven supports do not obstruct the interior dimensions required for the warming drawer.

**IMPORTANT NOTE:** In an overlay application, the amount of space between warming drawer and built-in oven openings may need to be increased depending on the size of the overlay panel and the amount of overlap.

- ▶ The Wolf warming drawer may be installed next to or above another Wolf warming drawer.
- ▶ The Wolf warming drawer with integrated drawer front may be installed in combination with a 30" (762) single built-in oven and microwave oven with 30" (762) trim. It may also be installed in combination with a 36" (914) built-in oven and microwave oven with 36" (914) trim.
- ▶ The Wolf warming drawer is designed and safe for use in outdoor applications. When installed outdoors, a ground fault circuit interrupter (GFCI) is required to reduce the risk of electrical shock. All other aspects of the installation are identical for indoor and outdoor use.
- ▶ Refer to the installation instructions shipped with each Wolf product for detailed specifications.